

INSTALLATION INSTRUCTIONS

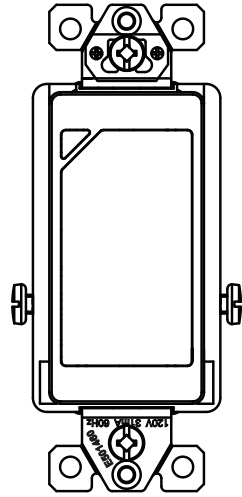

Model: TGFLGL
Decorator LED Full Guide Light

FEATURES

- Replaces any existing receptacle
- Full Guide Light with Daylight sensor
- Clamp-Type wire terminals are designed for easy installation from the back
- CUL Listed
- Built in, long lasting LED

SPECIFICATIONS

Input Voltage.....120VAC, 60Hz
Wire Terminals.....#14-#12 AWG
Operating Temperature..... -4 to 140°F (-20 to 60°C)
Device Dimension2-3/4"×1-1/2"×1-5/16"

WARRANTY

This device is warranted to be free of material and workmanship defects for 1 year from the date of purchase. Original receipt or proof of purchase from an authorized retailer must be presented upon warranty claim. ALL claims must be verified and approved by Top Greener, Inc. Warranties from other Top Greener products may vary. This warranty is nontransferable and does not cover normal wear and tear or any malfunction, failure, or defect resulting from misuse, abuse, neglect, alteration, modification, or improper installation. To the fullest extent permitted by the applicable state law, Top Greener shall not be liable to the purchaser or end user customer of Top Greener products for direct, indirect, incidental, or consequential damages even if Top Greener has been advised of the possibility of such damages. Top Greener' total liability under this or any other warranty, express or implied, is limited to repair, replacement or refund. Repair, replacement or refund are the sole and exclusive remedies for breach of warranty or any other legal theory

WARNING

Turn the power off at the circuit breaker before installing the Full Guide Light.

Read and understand these instructions before installing. This device is intended for installation in accordance with the National Electric Code and local regulations. It is recommended that a qualified electrician performs this installation. Make sure to turn off the circuit breaker or fuse(s) and make sure power is off before wiring the device.

Use copper wire only.

WIRING DIRECTIONS: CLAMP-TYPE TERMINAL

Turn off the power at the circuit breaker. Identify the HOT, NEUTRAL, and GROUND wires in the wall box. Insert wires into the terminal holes on the back side of the receptacle, then tighten the terminal screws to clamp wires in place.

- Insert the BLACK (LINE) wire into HOT terminal
- Insert the WHITE wires into the NEUTRAL terminal (With silver screw)
- Insert the GREEN/BARE (COPPER) wire into the GROUND terminal (Green screw)

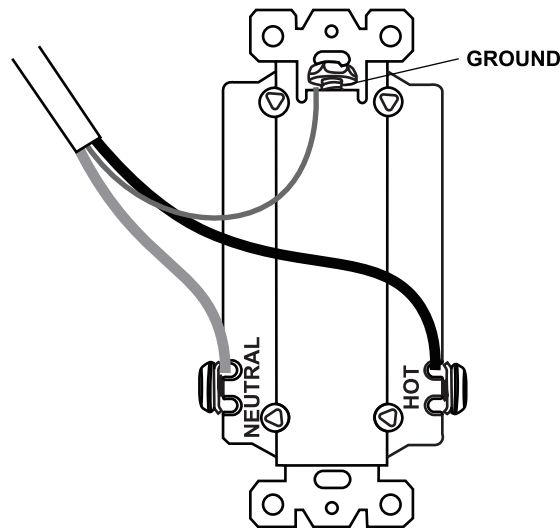

CHANGE FACE COVER

To remove the face cover, insert a flat screwdriver into tab at corners and pry cover off.

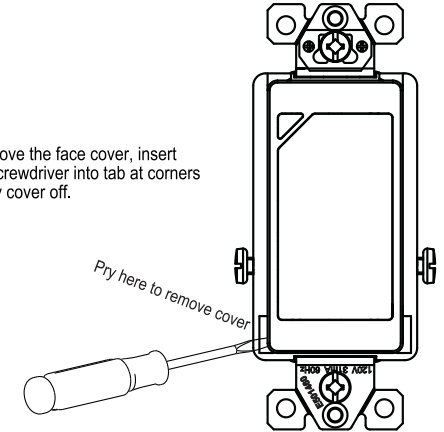

TOPGREENER®